

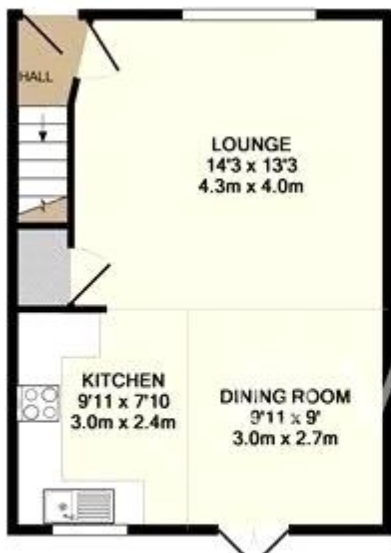

Marksbury Road Bristol
BS3
£1,850 pcm

Available UNFURNISHED from JUNE 2026! A bright three-bedroom mid-terrace with fresh décor, open-plan living, two parking spaces and a standout rear garden. Three double bedrooms and a newly renovated bathroom make it ideal for families or a MAXIMUM of 2 professionals sharers.



GROUND FLOOR
APPROX. FLOOR
AREA 390 SQ.FT.
(36.2 SQ.M.)



1ST FLOOR
APPROX. FLOOR
AREA 390 SQ.FT.
(36.2 SQ.M.)

TOTAL APPROX. FLOOR AREA 780 SQ.FT. (72.5 SQ.M.)
Made with Metropix ©2013

Whilst every effort is made to ensure the accuracy of these details, it should be noted that the measurements are approximate only. Floorplans are for representation purposes only and prepared according to the RICS Code of Measuring Practice by our floorplan provider. Therefore, the layout of doors, windows and rooms are approximate and should be regarded as such by any prospective tenant.

Energy Efficiency Rating

	Current	Potential
<i>Very energy efficient - lower running costs</i> (92+) A		
(81-91) B		88
(69-80) C	71	
(55-68) D		
(39-54) E		
(21-38) F		
(1-20) G <i>Not energy efficient - higher running costs</i>		
England & Wales	EU Directive 2002/91/EC	

The energy efficiency rating is a measure of the overall efficiency of a home. The higher the rating the more energy efficient the home is and the lower the fuel bills will be.

Reference

0117 441 6838

Additional Information

RL0032

Council Tax Band: B (Bristol City Council)

Deposit: £2,186.53

Holding Deposit: £437.30

Parking options: Driveway

Garden details: Rear Garden

Electricity supply: Mains

Heating: Gas Mains

Water supply: Mains

Sewerage: Mains

Whilst every effort is made to ensure the accuracy of these details, it should be noted that the measurements are approximate only. Floorplans are for representation purposes only and prepared according to the RICS Code of Measuring Practice by our floorplan provider. Therefore, the layout of doors, windows and rooms are approximate and should be regarded as such by any prospective tenant.